

POT DRAINAGE PIPE

Installation Manual

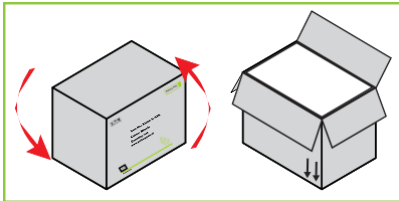

1. Make sure you have the accurate amount of Drainage Pipe(s) needed for your planter pot. Ask our sales Team for more information. Always order the needed drill with your Pot Drainage Pipe (ITEM 31-Drill35)!

2. Turn your product upside down, preferably still in the carton and open the bottom side of the carton.

3. Measure out the centre position of the Pot Drainage Pipe(s) you want to install.

4. Drill the holes gently with the drill. Let the drill do the work, be careful not to push the drill trough too fast; this might damage your planter or cause dangerous situations.

5. Use a vacuum cleaner to get rid of all the excess drilling dust.

6. Turn the planter including the carton on the side, open the top side of the carton and clean the rest of the excess drilling dust. Be careful not to scratch the outside of the pot!

7. Remove the nut and rubber ring from the Drainage Pipe and push the Drainage Pipe in the hole from the bottom side of the planter.

Place the rubber ring first and then tighten the nut by hand. .

8. Place the planter on its feet or use Pot feet to ensure there is space between the ground surface and the planter so that the water can drain off in the right way.

Remove the packaging. Be careful not to scratch the outside of the planter pot!

SIDE NOTES

AFTER PLACING THE POT DRAINAGE PIPE, THE PLANTER IS NO LONGER WATER TIGHT. IT'S RECOMMENDED TO USE A LINING IN COMBINATION WITH THE DRAINAGE PIPE TO MAKE SURE THE WATER LEAVES THE PLANTER AT THE DESIRED AREA.

COVER THE HOLES WITH MESH, TO MAKE SURE THE SOIL CANNOT CLOG THE DRAINAGE PIPE.

FILL THE PLANTER WITH 1/3 OF HYDRO GRAIN. THE HYDRO GRAINS CONTRIBUTE TO THE WATER MANAGEMENT AND MAKE SURE THAT YOUR PLANTS GROW BETTER.

IF YOU NEED TO FILL THE PLANTER WITH "EMPTY VOLUME" ITS RECOMMEND TO USE POLYSTYRENE FOAM ON THE WALLS AND BOTTOM OF THE PLANTER. MAKE SURE NOT THE BLOCK THE DRAINAGE PIPE.

Please consider our technical advice – be it verbally, in writing or testing and supplied to the best of our knowledge – as information only and without responsibility in respect to other parties. It does not release you from your obligation to test the products supplied regarding their suitability for the intended application. Handling and utilization of our products by the customer exceed our responsibility and are at the customer's liability. We guarantee that our products conform to their specification and we will only refund or replace non-conforming products. Pottery Pots cannot be held responsible for any damages or accidents in connection with the use of our product.

